



Designing the future

ORIGINAL

December 1, 2003

Magalie Roman Salas
Secretary
Federal Energy Regulatory Commission
888 First Street, N.E.
Washington, DC 20426

FILED
OFFICE OF THE
SECRETARY
2003 DEC -2 A 9 52
FEDERAL ENERGY
REGULATORY COMMISSION

Subject: Camp Far West Project, FERC No. 2997-027
License exhibit amendment to add three auxiliary dams to project
Contains Critical Energy Infrastructure Information - Do Not Release

Dear Secretary Salas:

On October 3, 2003, the Federal Energy Regulatory Commission issued a letter to the South Sutter Water District stating that the three auxiliary dams located around the rim of the Camp Far West Reservoir are not shown or mentioned in the approved project exhibits. The Commission requested that the South Sutter Water District file with the Commission revised license exhibits A, F, and G showing the three auxiliary dams. In response to the Commission's October 3, 2003 request, and on behalf of the South Sutter Water District, please find one original plus two copies of the revised license exhibits for the Camp Far West Project, FERC No. 2997 as follows:

- ▶ Revised Exhibit G, Sheet 1 Drawing showing the location of the south and north wing dams and the dike;
- ▶ Revised Exhibit F, Sheet 1 Drawing showing the south wing dam in plan view;
- ▶ New Exhibit F, Sheet 1A Drawing showing the plan views of north wing dam and dike and cross-section information for the south and north wing dams and the dike; and
- ▶ Addendum to Exhibit A Project Description to include narratives for the south and north wing dams and the dike.

Magalie Roman Salas, Secretary

December 1, 2003

Page 2

As requested, the abovementioned exhibits have also been provided to the Commission's San Francisco Regional Office. Please contact me if you have any questions or comments.

Sincerely,

MEAD & HUNT, Inc.

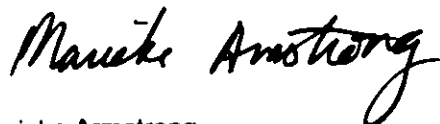
A handwritten signature in black ink that reads "Marieke Armstrong". The signature is written in a cursive, flowing style.

Marieke Armstrong

Enclosure

cc: Federal Energy Regulatory Commission, San Francisco Regional Office w/encl
Brad Arnold, South Sutter Water District w/o encl

**Addendum to Exhibit A
Camp Far West Project
FERC No. 2997
Project Description for North Wing Dam, South Wing Dam, and Dike**

EXISTING FACILITIES

AUXILLIARY DAMS

Adjacent to the left abutment of the main embankment is the south wing dam constructed of earthfill with a maximum height of 45 feet, a crest width of 20 feet and length of 1,060 feet. Constructed to the north of the main embankment opposite the spillway is a second earthfill wing dam which is 25 feet in height, 20 feet in width at the crest, and 1,460 feet in length. The upstream slopes of the south and north wing dams are 2.5 to 1 and 3 to 1, respectively. The downstream slopes of both wing dams are 2.5 to 1.

The north and south wing dams are constructed of compacted clays and silts. The upstream outside slope of the two wing dams is covered with 3 feet of riprap underlain by an 18" layer of gravel bedding. The downstream slope of the south wing dam is protected by a layer of riprap with a minimum thickness of 3 feet.

An earthfill dike was also constructed to the north of the north wing dam at a height of 12 feet, a crest length of 1,450 feet and a crest width of 20 feet. The elevation at the top of the dike is 320 msl.

**FILED
OFFICE OF THE
SECRETARY
2003 DEC -2 A 9 52
FEDERAL ENERGY
REGULATORY COMMISSION**

LARGE-FORMAT IMAGES

One or more large-format images (over 8 1/2" X 11") go here.
These images are available in FERRIS at:

For Large-Format(s):
Accession No.: 2003/203-0206

Security/Availability:

- PUBLIC
- NIP
- CEII
- NON-PUBLIC/PRIVILEGED

File Date: DEC 2, 03 Docket No.: P2997

Parent Accession No.: 2003/203-0205

Set No.: 1 of 1

Number of page(s) in set: 3

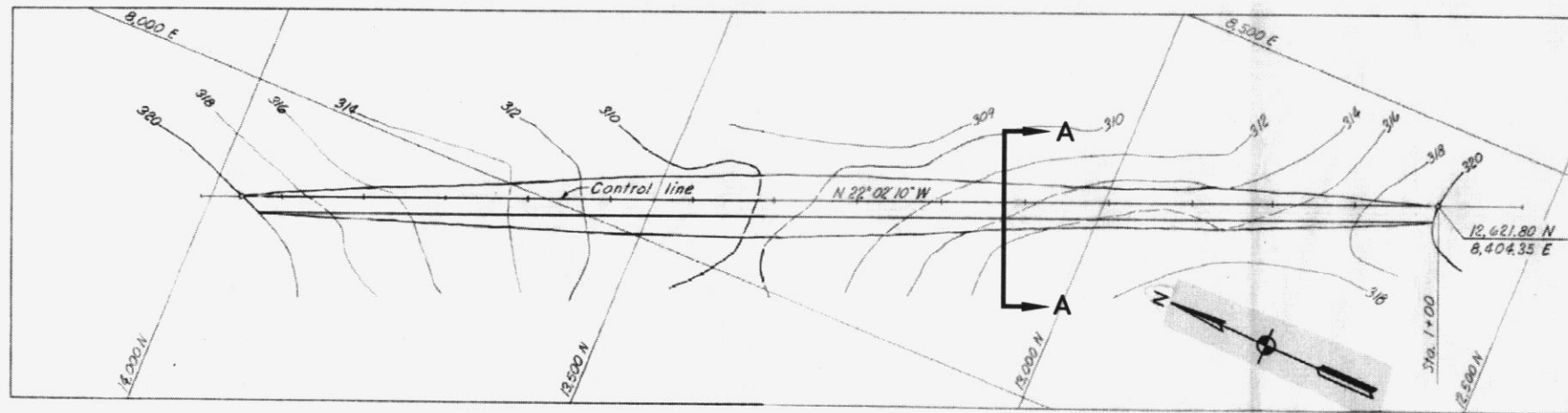
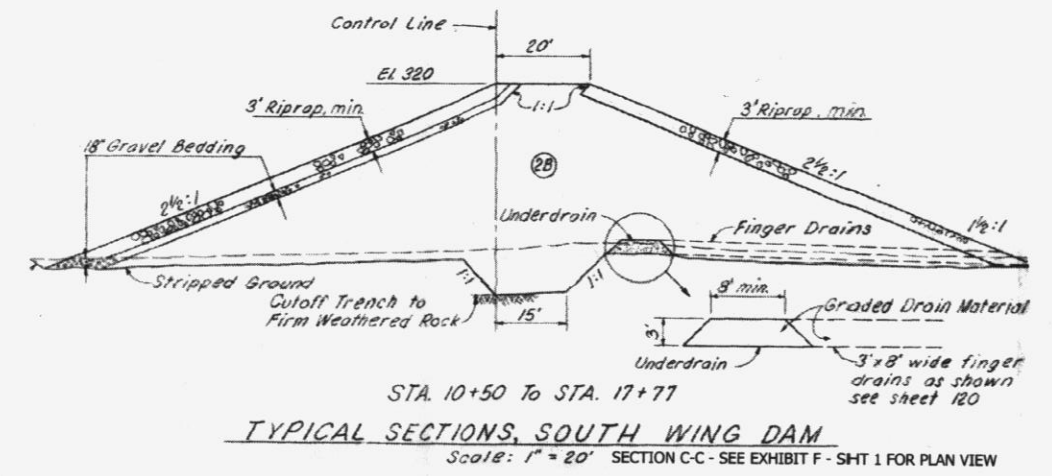
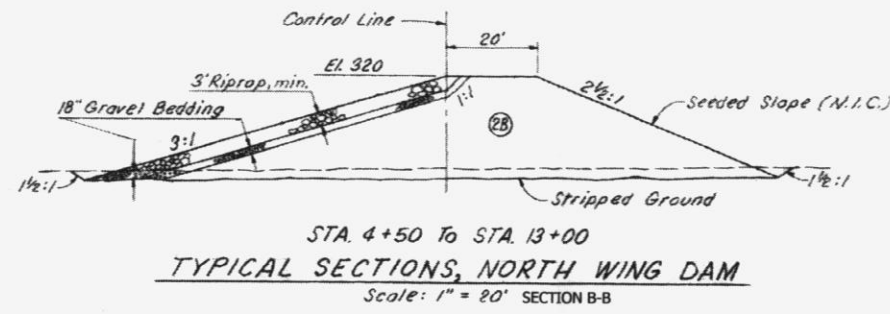
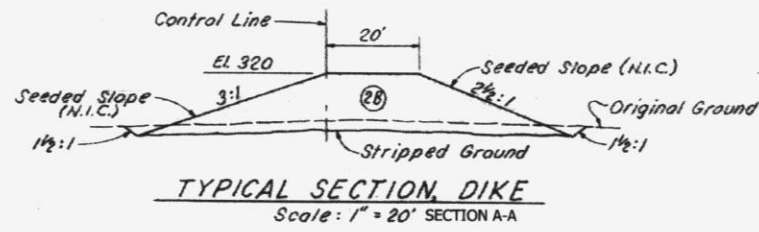

PLAN OF DIKE
Scale: 1" = 100'

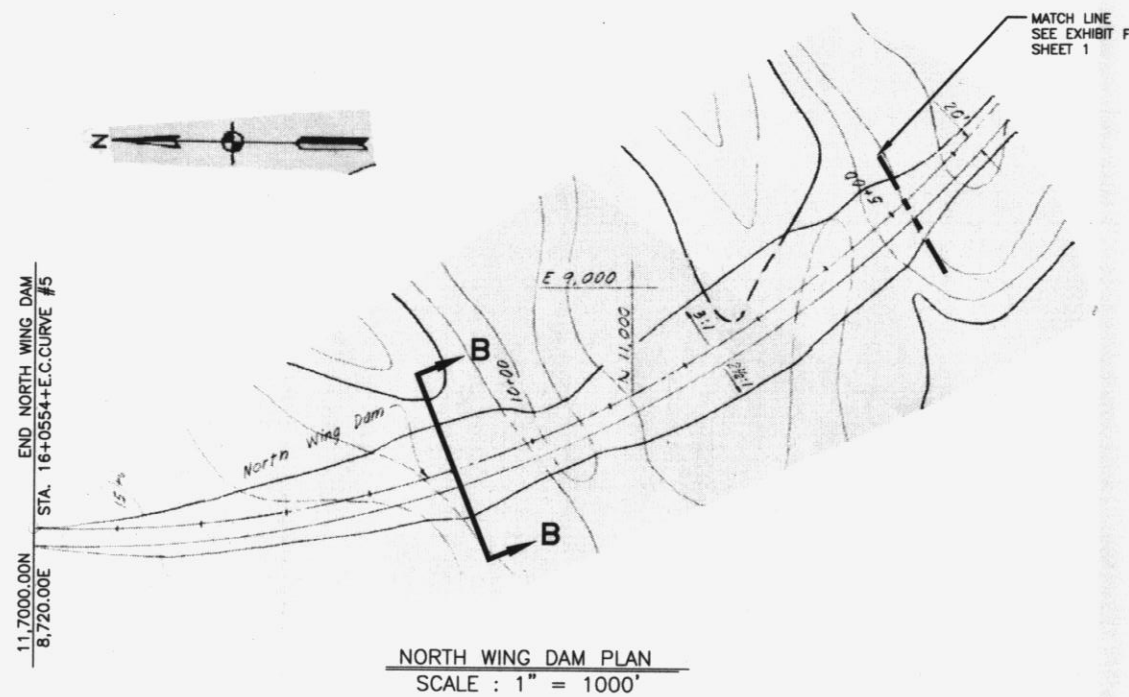

NORTH WING DAM PLAN
SCALE: 1" = 1000'

NOTE
THIS PLAN WAS PREPARED USING INFORMATION FROM McCREARY-KORETSKY & MCGUIRE, SOUTH SUTTER WATER DISTRICT, CAMP FAR WEST PROJECT - SPILLWAY & NORTH WING DAM PLAN, DAM PROFILES AND DIKE PLAN & PROFILE AND ALSO DAM SECTIONS. DATED 7-18-61 & 3-31-62.

EXHIBIT F SHEET IA
EXISTING & PROPOSED FACILITIES
CAMP FAR WEST DAM & RESERVOIR
WATER POWER PROJECT
Owner: SOUTH SUTTER WATER DISTRICT
CONTAINS CRITICAL ENERGY INFRASTRUCTURE INFORMATION - DO NOT RELEASE
 MEAD HUNT <small>ENGINEERS ARCHITECTS SCIENTISTS PLANNERS</small> <small>3327 Longview Drive North Highlands, California 95660 Phone: (916) 971-3961 Fax: (916) 971-4578</small>
Public 11-25-03

031203-0206-01-002

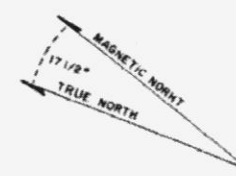
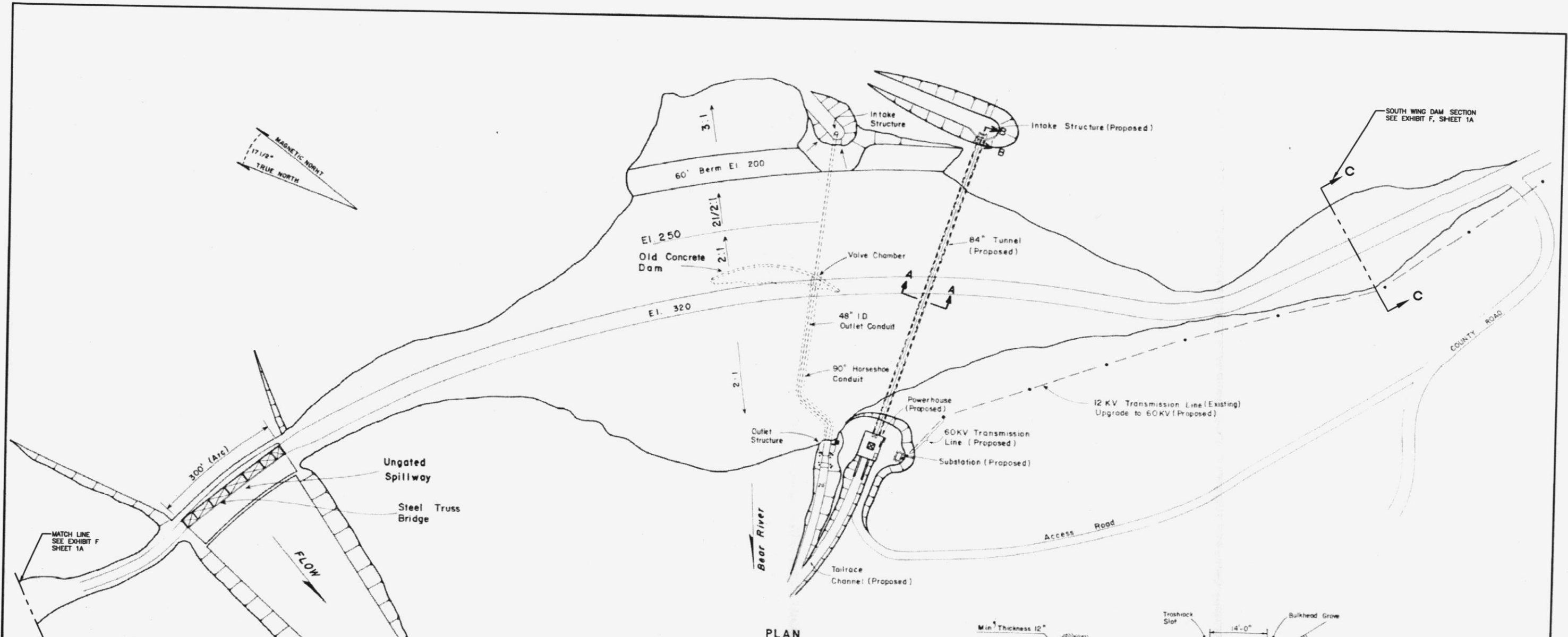

SOUTH WING DAM SECTION
SEE EXHIBIT F, SHEET 1A

- ZONE DESCRIPTION**
- ① Selected clayey gravels & silty clays
 - ② Selected silty clays & clayey silts
 - ③ Selected sand, gravel & cobbles
 - ④ Selected fine rock
 - ⑤ Quarry run rock

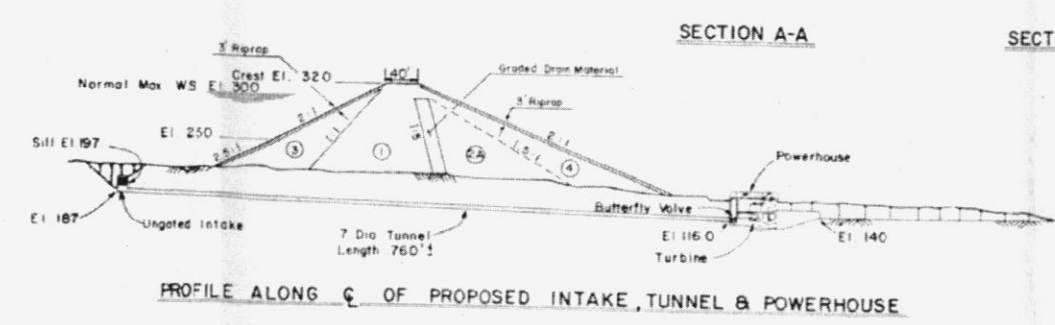
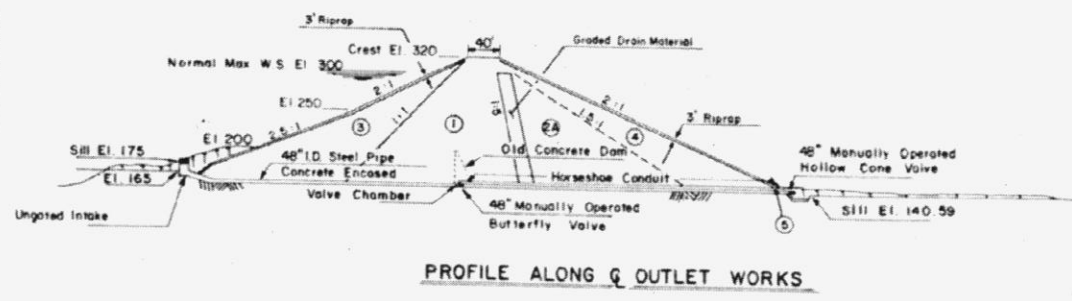
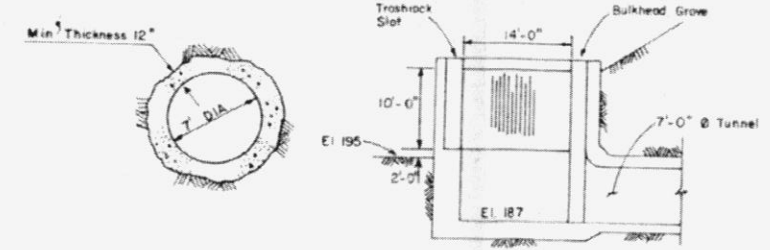
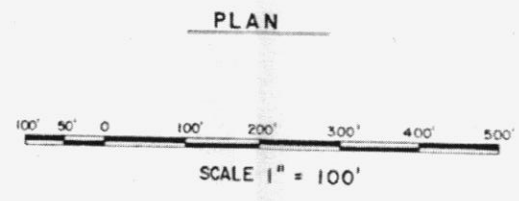

EXHIBIT F SHEET I	
EXISTING & PROPOSED FACILITIES	
CAMP FAR WEST DAM & RESERVOIR	
WATER POWER PROJECT	
Owner: SOUTH SUTTER WATER DISTRICT	Engineer: PARSONS BRINCKERHOFF QUADE & DOUGLAS INC.
CONTAINS CRITICAL ENERGY INFRASTRUCTURE INFORMATION - DO NOT RELEASE	
<i>Public</i>	
<small>3327 Longview Drive North Highlands, California 95660 Phone: (916) 971-3961 Fax: (916) 971-0578</small>	
REVISED 11-25-03	

2997-1
03/203-0206-01-001

